

Daytona

BP-9A **9,000 LBS 2-POST** **FLOORPLATE LIFT**



BP-9A

Note: Product may vary slightly from image shown

Features

- 9,000 lbs lifting capacity
- Automatic safety locks, with single point release
- High polymer polyethylene wear resistant slide blocks
- Chain over hydraulic cylinders
- Screw up pads
- Height limit switch
- Rubber door guards
- Powder coat finish for durability
- Three stage front arms
- Truck adapters standard

Daytona

BP-9A 9,000 LBS 2-POST FLOORPLATE LIFT

Specifications

Power - 240V 3HP 13A PH1 60Hz

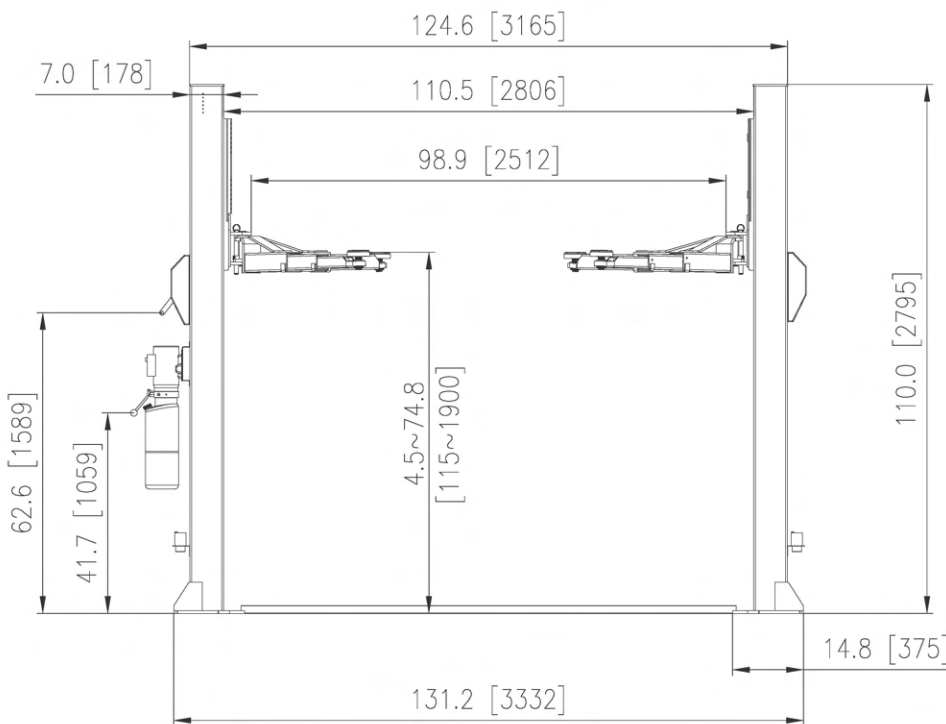

DIMENSIONS, COLOURS AND ITEMS ARE SUBJECT TO CHANGE WITHOUT PRIOR NOTICE DUE TO OUR CONTINUOUS IMPROVEMENT PROGRAM

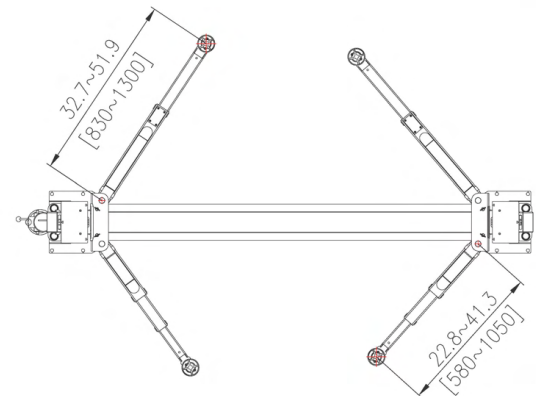
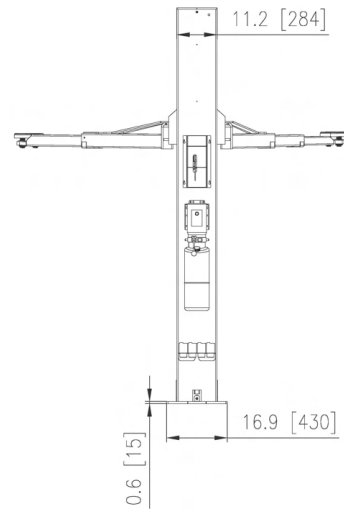

Shipping Dimensions: Lift 114" x 18" x 30" 1300lbs
Pump 31" x 12" x 11" 60lbs

720 W. Myers Blvd, Mascotte, FL 34753

407-325-4515 - Liftman53@Gmail.com

Florida Lift Experts