

Daytona

PRO-10-XLT
10,000 LBS 4-POST
PARKING LIFT
Extra long and Tall

Features

- Four mechanical locking devices, each equipped with both primary and secondary safety locks
- Single point manual safety release
- Removable Aluminum approach ramp
- Large heavy duty 3.5" cylinder
- Aircraft quality lifting cables
- Matted powder coat finish
- Adjustable runways
- Pump can be mounted on any post



PRO-10-XLT

Note: Product may vary slightly from image shown

Please Note: Optional Rolling Jacks and Wheel Kits are sold separately. Our 10,000lb Parking lift comes with 1 steel tool tray and 3 plastic drip trays

Daytona

PRO-10-XLT 10,000 LBS 4-POST PARKING LIFT *Extra Long and Tall*

Specifications

Power - 120V 1.5HP 26Amp 1 PH 60Hz

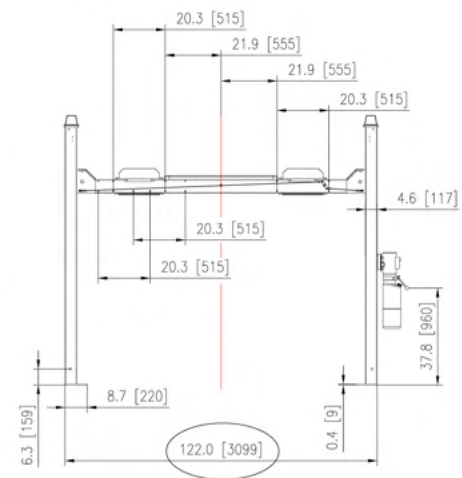
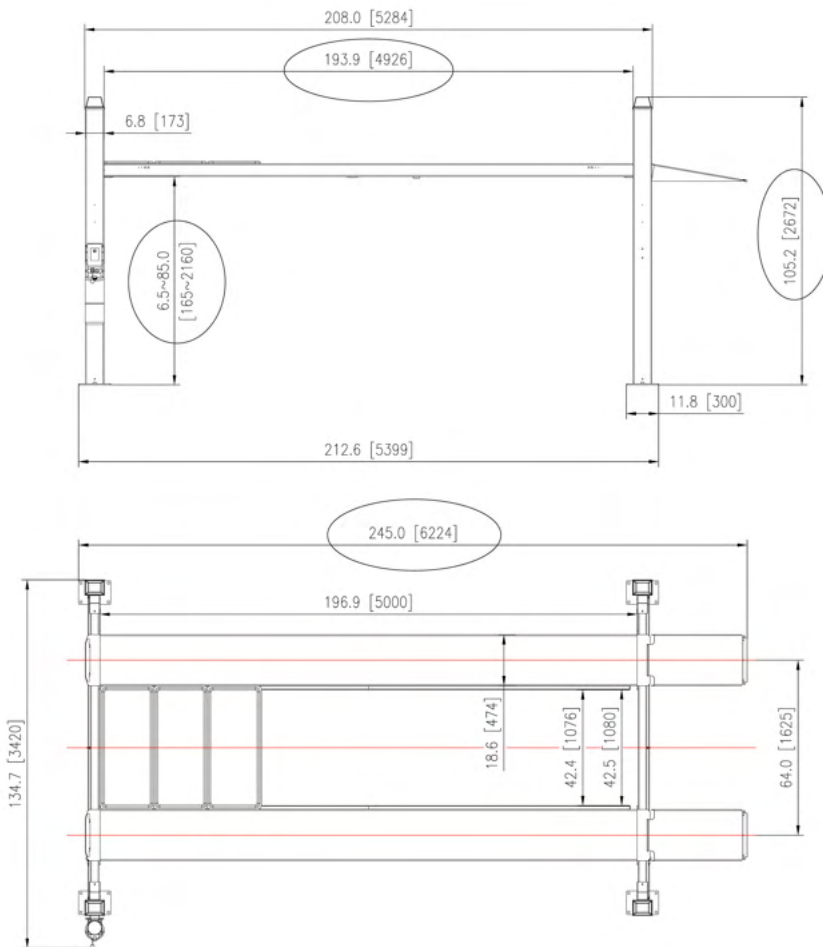

DIMENSIONS, COLOURS AND ITEMS ARE SUBJECT TO CHANGE WITHOUT PRIOR NOTICE DUE TO OUR CONTINUOUS IMPROVEMENT PROGRAM

Shipping Dimensions: Lift 207" x 22" x 33" 2700lbs
Pump attached to lift. Included in dimensions
Optional Wheel Kit 40" x 24" x 10" 120lbs

720 W. Myers Blvd, Mascotte, FL 34753
407-325-4515 - Liftman53@Gmail.com

Florida Lift Experts